

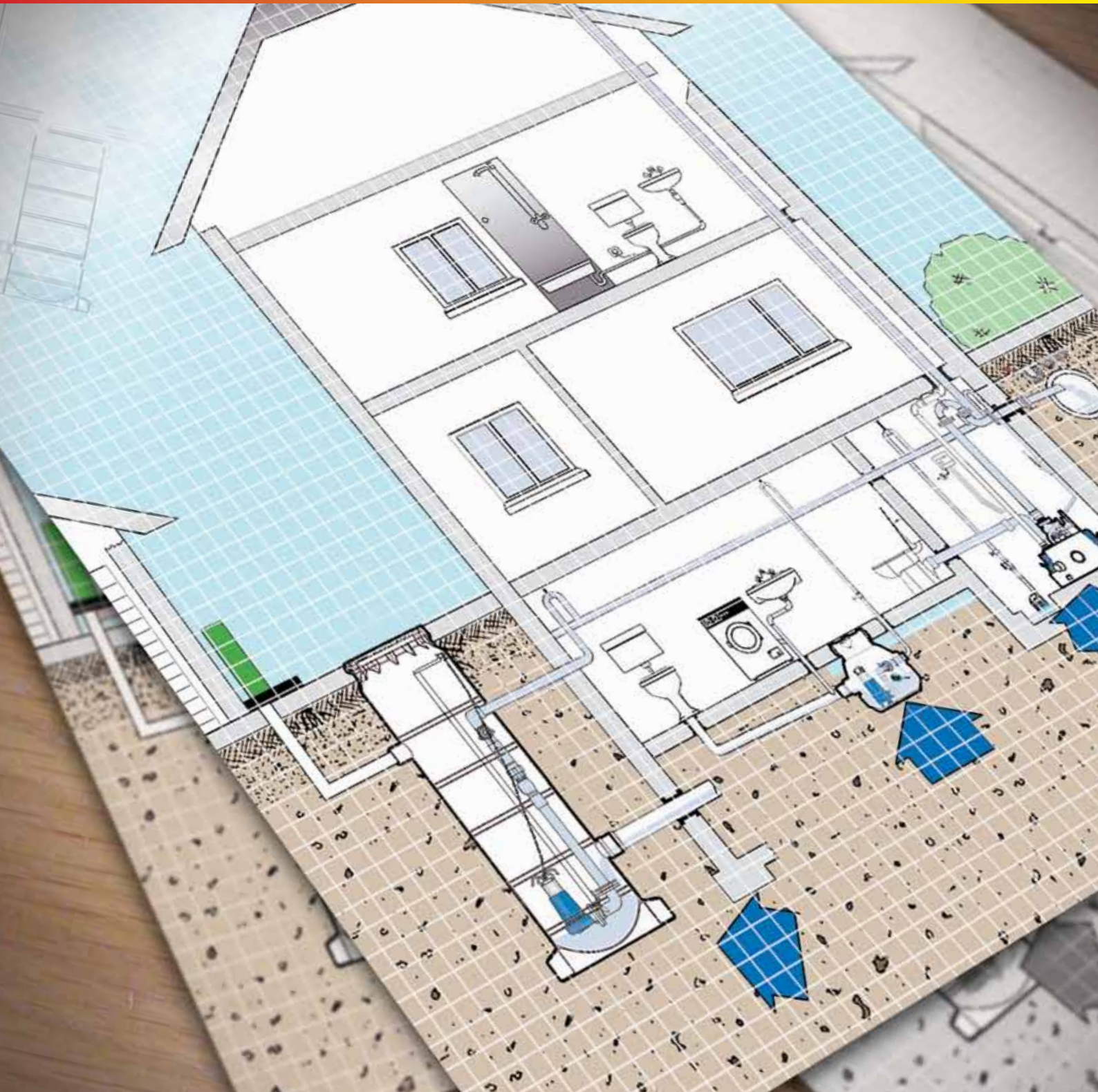

For more information go to [www.barbourproductsearch.info](http://www.barbourproductsearch.info)

packaged **pump** solutions



# Packaged Pump Stations

DELTA MEMBRANE SYSTEMS LIMITED

BASSETT BUSINESS CENTRE, HURRICANE WAY, NORTH WEALD, EPPING, ESSEX CM16 6AA

t: 01992 523811 f: 01992 524046 e: [pumps@deltamembranes.com](mailto:pumps@deltamembranes.com) [www.deltamembranes.com](http://www.deltamembranes.com)

# Standard basement pump stations



## Delta Single V3 Sump (DMS 047)

A packaged pump station designed to collect groundwater through the clear opening in the top of the chamber via a Delta cavity membrane system. This pump station would be selected in applications where no running water is present or expected, and therefore it is offered for protection of the membrane only, in accordance with BS.8102.



## Delta Dual V3 Sump - 2 x V3 pumps (DMS 164)

A packaged pump station designed to collect ground water through the top opening, and/or via the three 110mm inlets, for example, the collection of water from the light wells. The packaged pump station can also collect grey water from sinks, showers, washing machines, and dishwashers but not foul water from a W.C.

The side inlets also provide a useful means of collecting water from restricted areas by means of 110mm drainage pipe set in the floor.

See DELTA detail 129-V3 or seek our advice.



## Delta Foul V3 Sump (DMS 165)

A packaged pump station designed to collect foul water in a basement application where there are other facilities in the property are on gravity drainage. The package consists of one DELTA 501X solids handling pump, which is designed to collect foul water from W.C's, and grey water from hand basins, showers and baths. It is not recommended to collect ground water via a Delta cavity membrane system, this should be managed separately.

The DMS 165 also includes an alarm.

Seek our advice for selection.



# Below Ground Pump Stations



## Overview

We offer an extensive range of Packaged Pump Stations to meet all your sewage and drainage needs for Domestic or Commercial applications.

## Applications:

- Ground water
- Surface water
- Foul water

## Sizes

- Diameters from 600 - 2500mm
- Depths from 650 - 6000mm

## Specifications:

- Manufactured in GRP or High density Polyethylene
- Compliant with BS 752
- Single or dual pumps
- Single or three phase
- Guide Rail mounted & free standing
- Vortex, channel or macerator
- Ductile iron or UPVC pipe work

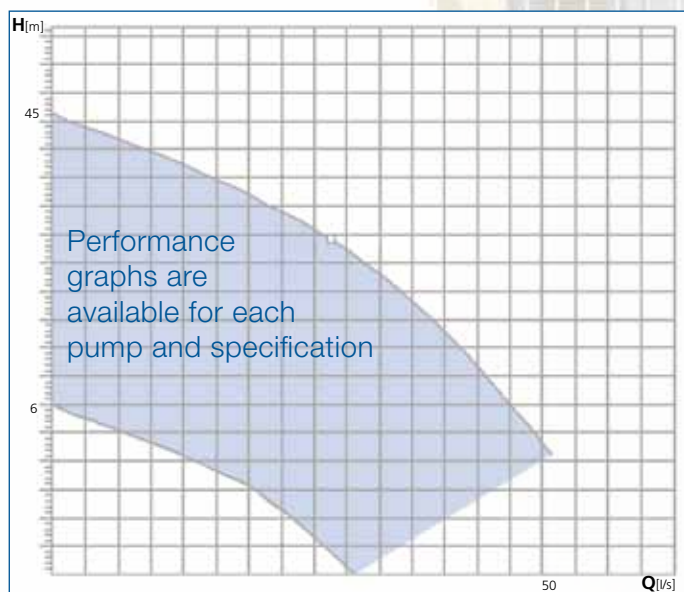

# After Sales Service

PPS provide comprehensive maintenance and service support for all installations of Delta packaged stations.

They have a team of fully trained service engineers who are able to maintain both Delta manufactured equipment as well as those of other suppliers.

They offer both one off servicing and repairs as well as preventative maintenance agreements. Clients who are on a service agreement have access to a 24hr/365 day call out facilities.

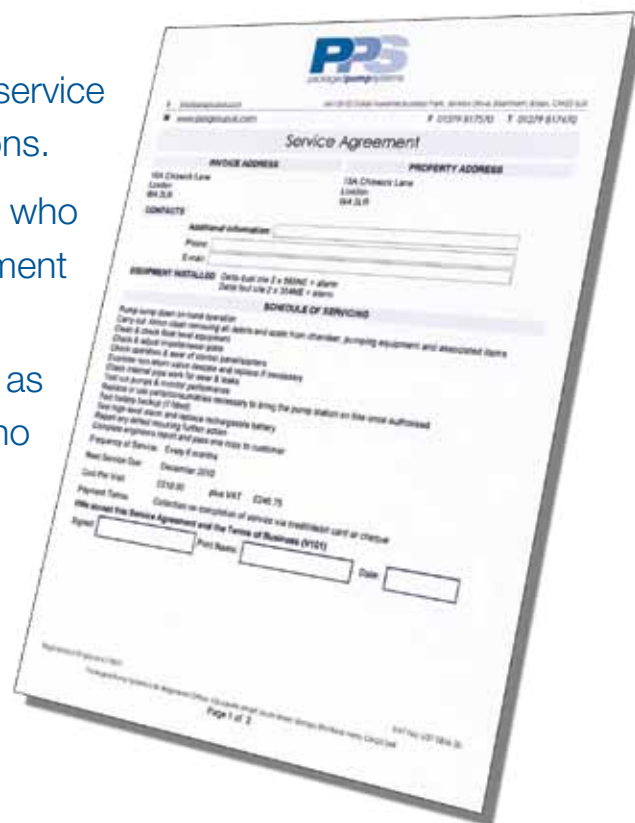

- Fully stocked vans
- Emergency breakdown service
- Out of hours service
- Planned maintenance
- Factory trained engineers